

Google Classroom: A guide for parents and carers

Google Classroom is a web-based learning environment. When logged into Google Classroom, pupils can collaborate with their peers and the staff who work with their class. Google Classroom offers a digital safe space for pupils to view class tasks, access learning materials, view posted assignments, and hand in completed work. Home learning tasks appear automatically (at the scheduled time), and all the related documents and final work are securely saved in one place... so they cannot be forgotten or go missing!

To log on, children need to log in to <https://classroom.google.com/>.

Your child's details have been shared with you via myUSO.

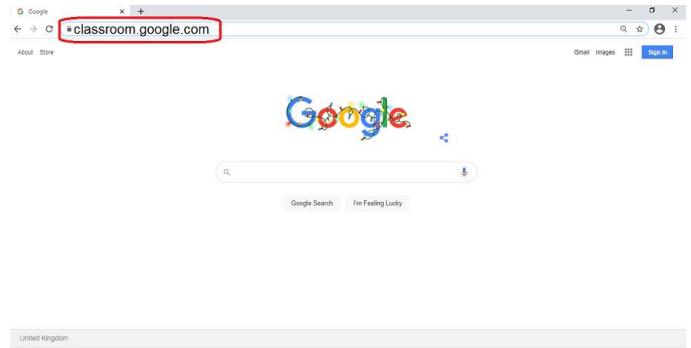

Your child needs to enter their email address and password, and agree to the terms and conditions:

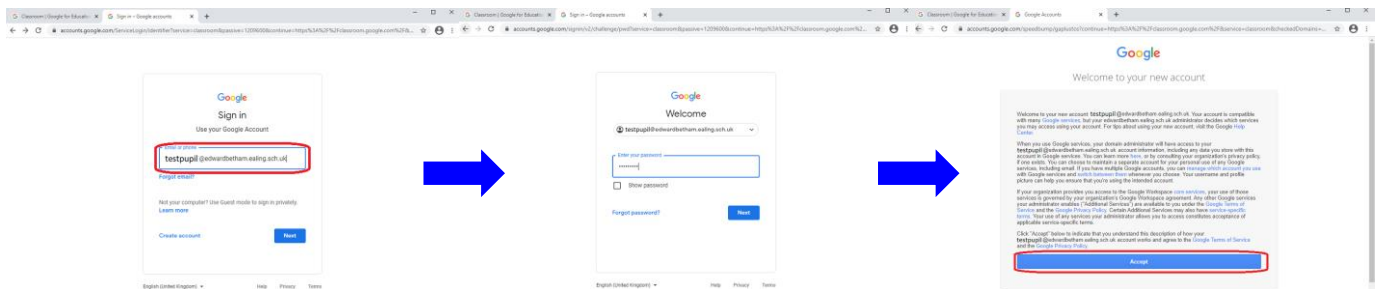

Click on **Continue**. Click **I'm a student**, then click on the + in the right-hand corner to join your classroom.

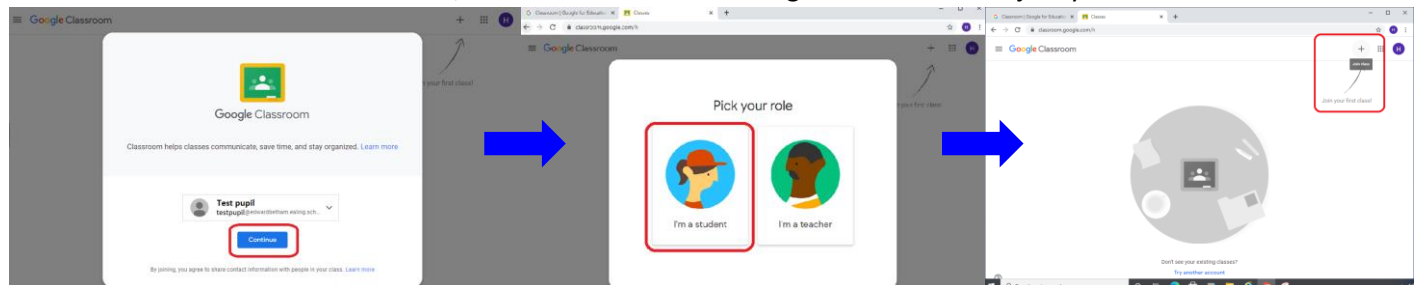

Your child's class code has been shared via myUSO.

When you have entered the code, press return, then click on the blue **Join** button in the right-hand corner.

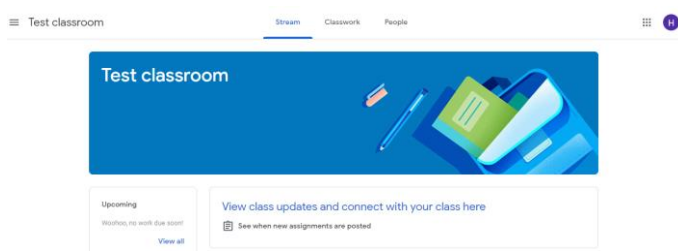
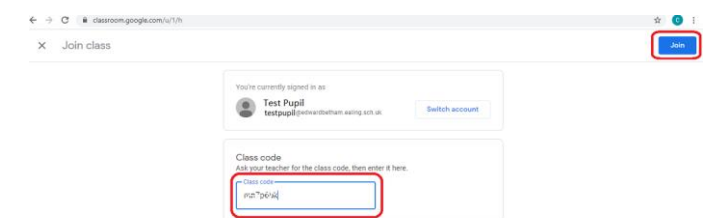

Your child will now be a member of their Google Classroom.